

# ATELIER *delle* FINITURE

2025

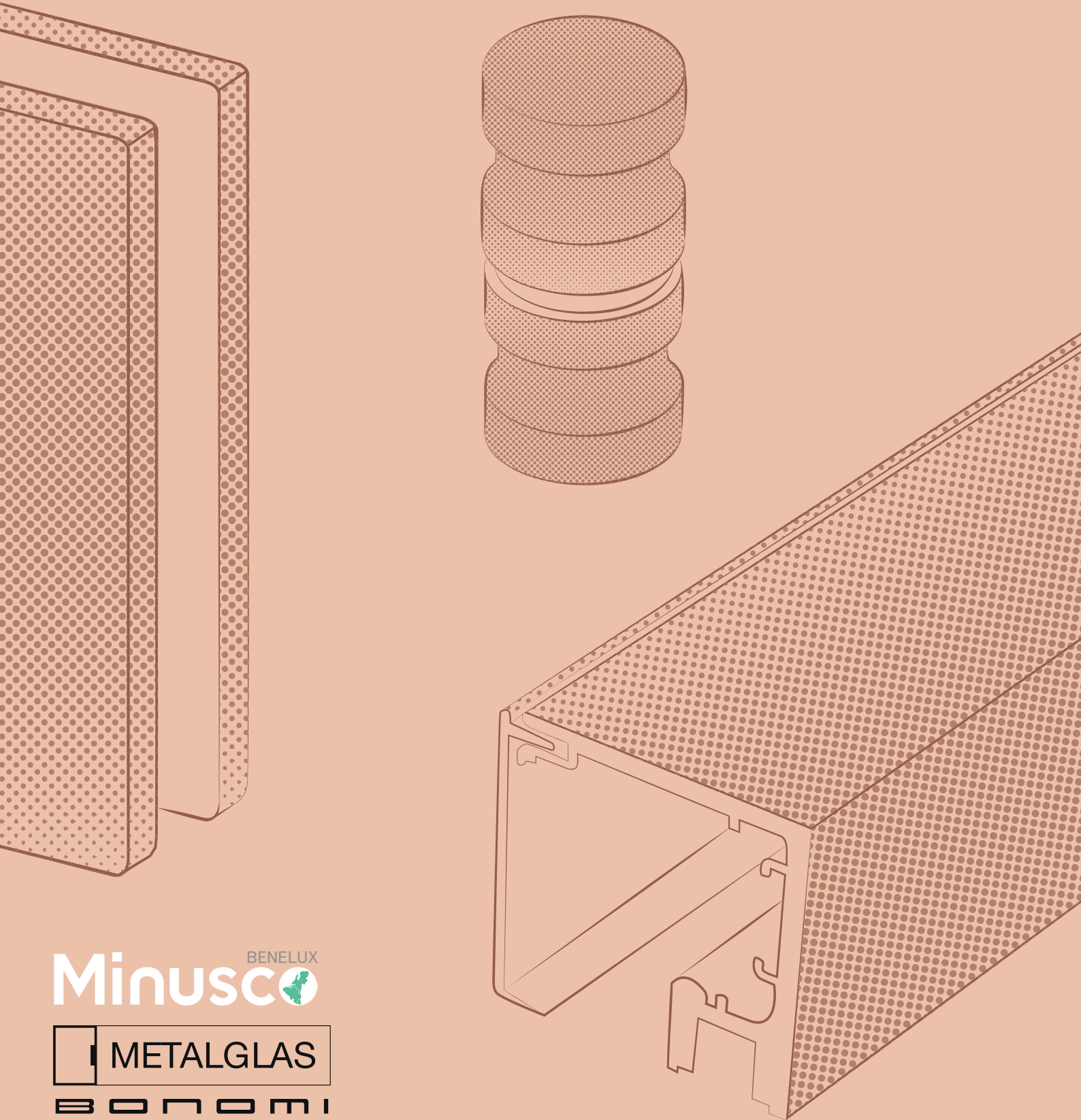

Minusco BENELUX

METALGLAS

BONOMI



# ATELIER *delle* FINITURE

From a single raw material—aluminum—to the finished product, achieved through a single coloring process. This is the origin of ATELIER DELLE FINITURE, which offers numerous aesthetic and practical advantages:

- visual harmony
- greater perception of space
- increased aesthetic and perceived value
- ease of maintenance

Van één grondstof – aluminium – tot eindproduct, met één kleurproces.

Zo is ATELIER DELLE FINITURE ontstaan, met talloze esthetische en praktische voordelen:

- visuele harmonie
- betere ruimtelijke beleving
- hogere esthetiek en visuele waarde
- onderhoudsgemak

D'une seule matière première – l'aluminium – au produit fini obtenu grâce à un seul procédé de coloration.

C'est ainsi qu'est né ATELIER DELLE FINITURE, qui offre de nombreux avantages esthétiques et pratiques :

- harmonie visuelle
- meilleure perception de l'espace
- valeur esthétique et perçue accrue
- facilité d'entretien

# FROM ALUMINUM TO THE ATELIER DELLE FINITURE

VAN ALUMINIUM NAAR ATELIER DELLE FINITURE  
DE L'ALUMINIUM À L'ATELIER DELLE FINITURE



ATELIER *delle*  
FINITURE

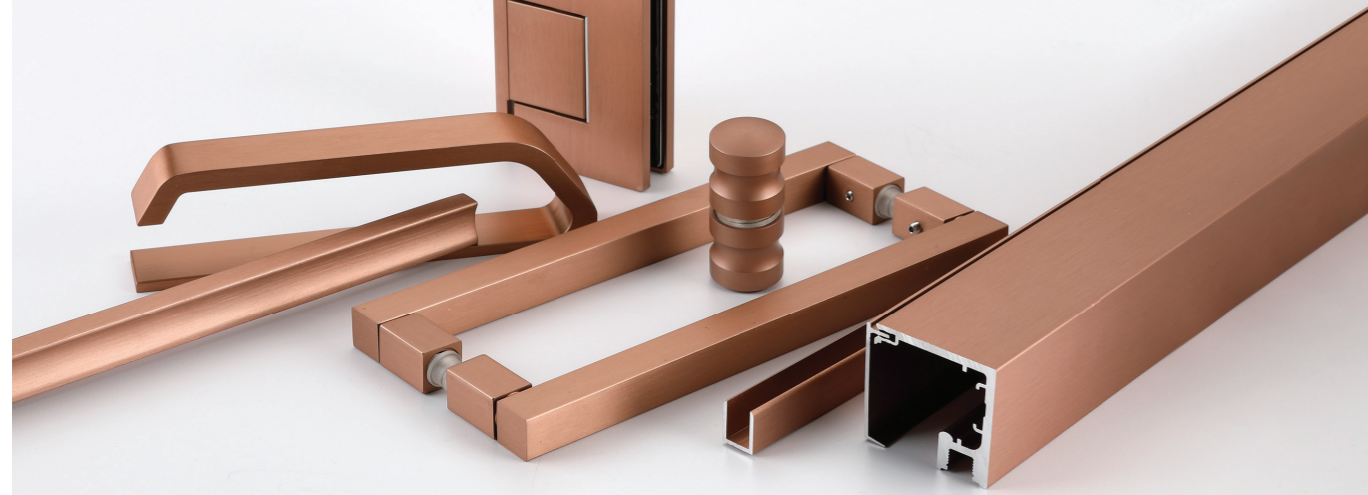

• The collection is made using CNC (computer numerical control) milling, a subtractive process where material is removed from a raw block using rotating cutting tools to achieve the desired shape.

Milling aluminum can cost up to ten times more than die-casting zamak because:

- aluminum is generally more expensive than zamak;
- the process requires more time and specialized machinery;
- it generates more waste;
- it is ideal for small production runs;
- every detail must be planned in advance; if measurements are wrong, the parts won't match and active components, such as hinges, will not work.

De collectie is gemaakt met behulp van CNC-frezen, een subtractief proces waarbij materiaal met roterende snijgereedschappen uit een ruw blok wordt weggenomen om de gewenste vorm te bekomen. Het frezen van aluminium kan tot tien keer duurder zijn dan spuitgieten van zamak, omdat:

- aluminium over het algemeen duurder is dan zamak;
- het proces meer tijd en gespecialiseerde machines vereist;
- het meer afval genereert;
- het ideaal is voor kleine productieseries;
- elk detail vooraf moet worden gepland; als de metingen verkeerd zijn, passen de onderdelen niet en werken actieve componenten, zoals scharnieren, niet.

• La collection est réalisée par fraisage CNC (commande numérique par ordinateur), un procédé soustractif dans lequel la matière est retirée d'un bloc brut à l'aide d'outils de coupe rotatifs pour obtenir la forme souhaitée.

Le fraisage de l'aluminium peut coûter jusqu'à dix fois plus cher que le moulage sous pression du zamak parce que :

- l'aluminium est généralement plus cher que le zamak ;
- l'usinage demande plus de temps et des machines spécifiques ;
- il génère plus de déchets ;
- il est idéal pour des séries en quantités limitées ;
- chaque détail doit être anticipé ; si les mesures sont incorrectes, les composants ne s'adaptent pas et les éléments actifs, comme les charnières, ne fonctionnent pas.

# FINISHING RANGE

GAMMA VAN FINISHES  
GAMME DE FINITIONS

ATELIER *delle*  
FINITURE

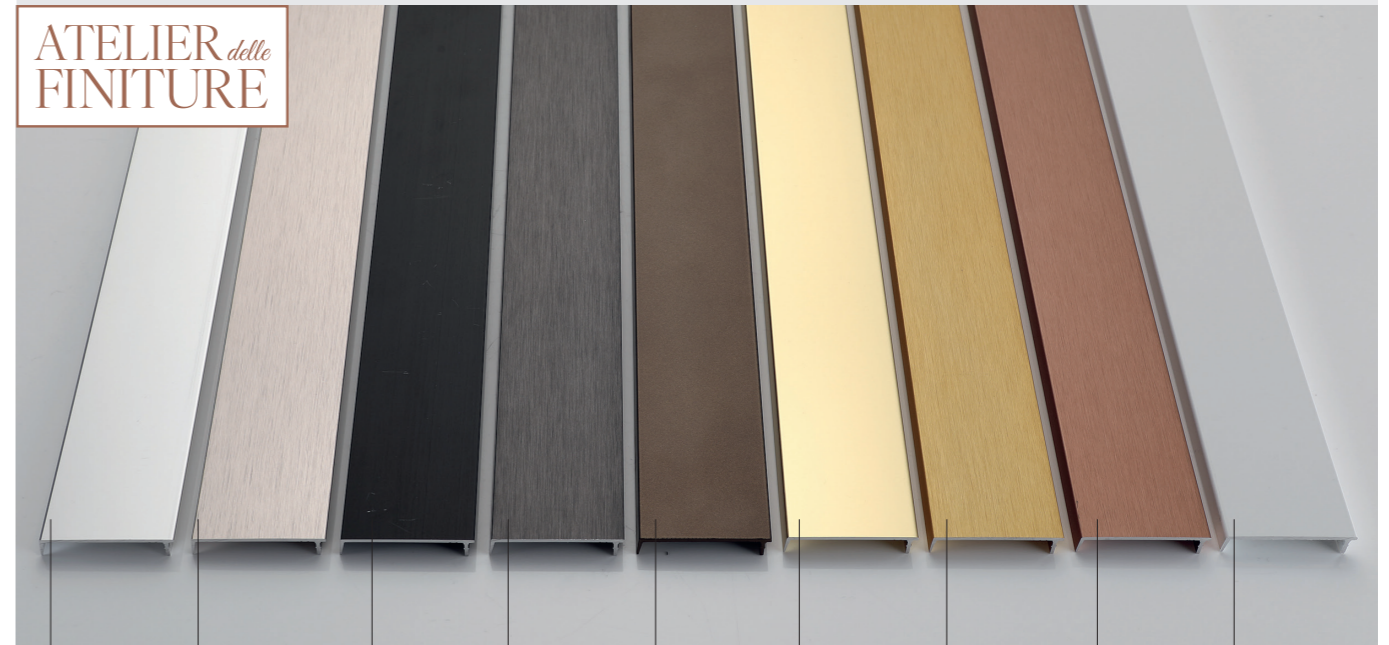

CR Polished Chrome Gepolijst chroom Chromé Poli	IX Inox Effect Effect Inox Effet Inox	NO Matt Black Mat zwart Noir Mat	CF Gunmetal Grey Metallic grijs Gris Acier	BV Dark Bronze Donker brons Brun Foncé	OL Polished Brass Gepolijst Messing Laiton Poli	OS Satin Gold Satijn goud Or Satiné	RM Satin Copper Satijn koper Cuivre Satiné	BI Matt White Mat wit Blanc Mat
Finish by anodic oxidation Afwerking door anodische oxidatie Finition par oxydation	Finish by anodic oxidation Afwerking door anodische oxidatie Finition par oxydation	Finish by anodic oxidation Afwerking door anodische oxidatie Finition par oxydation	Finish by anodic oxidation Afwerking door anodische oxidatie Finition par oxydation	Finish by painting Afwerking gelakt Finition obtenue par peinture	Finish by anodic oxidation Afwerking door anodische oxidatie Finition par oxydation	Finish by anodic oxidation Afwerking door anodische oxidatie Finition par oxydation	Finish by anodic oxidation Afwerking door anodische oxidatie Finition par oxydation	Finish by painting Afwerking gelakt Finition obtenue par peinture

# TYPES OF SHOWER ENCLOSURES

SOORTEN DOUCHEWANDEN  
TYPES DE CABIN DE DOUCHE

HINGED DOOR  
PUERTA BATIENTE  
PORTE BATTANTE

VANITY  
B-751 / B-752 / B-753 / B-196  
POR-0408 / SQUARE15

SLIDING DOOR  
PUERTA CORREDERA  
PORTE COULISSANTE

BX-5000  
BX-4000

WALK-IN

B-220  
B-136 / B-137 / B-138  
P-017  
BX-PT-C58 / BX-PT-C56

SHOWER BOXES

SHOWER BOXES

# VANITY

ALL-IN-ONE: Vanity redefines the concept of design flexibility.  
 ALL-IN-ONE: Vanity vernieuwt het concept van ontwerpflexibiliteit.  
 TOUT EN UN: Vanity redéfinit le concept de flexibilité de conception.

Product overview



P782

ATELIER *delle*  
FINITURE



SHOWER BOXES

SHOWER BOXES

# VANITY

ATELIER *delle*  
FINITURE

VANITY SET 1



VANITY SET 2



VANITY SET 3



VANITY SET 3

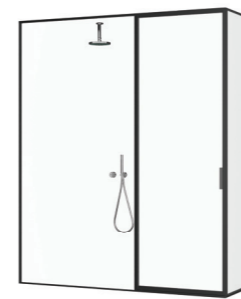

VANITY SET 5

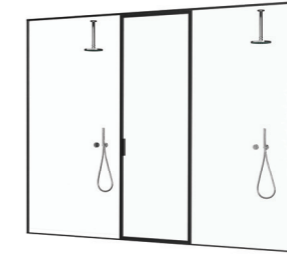

VANITY SET 6

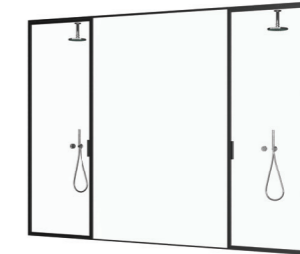

VANITY SET 7



VANITY SET 8



VANITY SET 9



xme705

CR IX NO CF BV OL OS RM BI

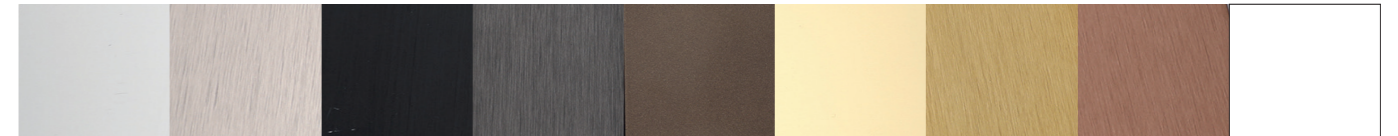

# VANITY

FEATURES  
FUNCTIES  
CARACTÉRISTIQUES TECHNIQUES

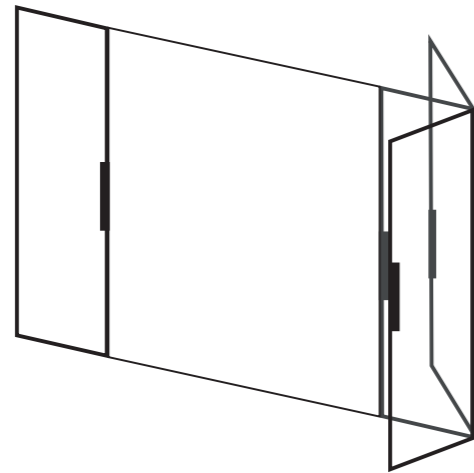

- Inward and outward opening
- Naar binnen en naar buiten openend
- Ouverture vers l'intérieur et l'extérieur

- Minimal perimeter profiles
- Minimale kaderprofielen
- Profils de périmètre minimaux



- Bottom hinge with lift-lower function
- Onderste scharnier met liftfunctie
- Charnière inférieur levante

# VANITY

ATELIER *delle*  
FINITURE



Open



Closed

- The magnetic gaskets are hidden inside the vertical profiles
- De magneetprofielen zijn verborgen in de verticale profielen
- Les joints magnétiques sont cachés à l'intérieur des montants

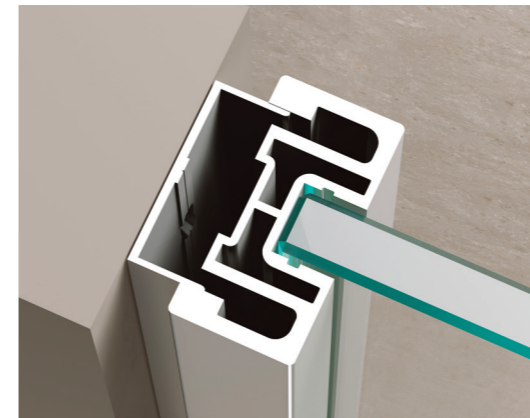

- Adjustable wall profiles
- Verstelbare wandprofielen
- Profils au mur réglables



- Double bottom gasket
- Dubbele bodempakking
- Joint double au sol



- Water drainage module
- Waterafvoermodule
- Module d'évacuation des eaux



- Free-standing installation
- Vrijstaande installatie
- Installation autoportante

# CLICKING HINGES

KLIKSCHARNIEREN  
CHARNIÈRES AVEC ARRÊT

Product overview



P623



ATELIER *delle*  
FINITURE

SHOWER BOXES

SHOWER BOXES



## B-751

- Adjustable glass to wall clicking hinge, no visible screws. Material: Aluminium.
- Verstelbaar scharnier voor wand/glas geen zichtbare schroeven. Materiaal: aluminium.
- Charnière à retenue réglable, mur/verre, avec vis non apparente. Matériau : Aluminium.



## B-752

- Adjustable 90° glass-to-glass double action clicking hinge, no visible screws. Material: Aluminium.
- Verstelbaar 90° glas-glas dubbelwerkend scharnier, geen zichtbare schroeven. Materiaal: aluminium.
- Charnière en angle à 90°, verre/verre, avec vis non apparente. Matériau : Aluminium.



## B-753

- Adjustable 90° glass-to-glass double action clicking hinge, no visible screws. Material: Aluminium.
- Verstelbaar 90° glas-glas dubbelwerkend scharnier, geen zichtbare schroeven. Materiaal: aluminium.
- Charnière en angle à 90°, verre/verre, avec vis non apparente. Matériau : Aluminium.



# ADJUSTABLE ANGLE STABILIZER BRACKET

VERSTELBAAR HOEKSTABILISATIE  
ÈQUERRE DA STABILISATION

Product overview



P795

ATELIER *delle*  
FINITURE

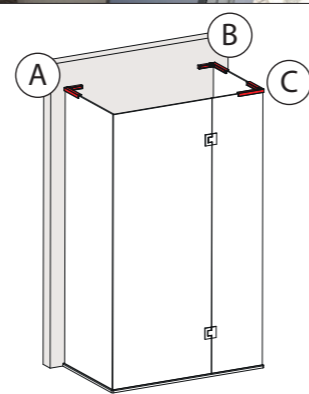
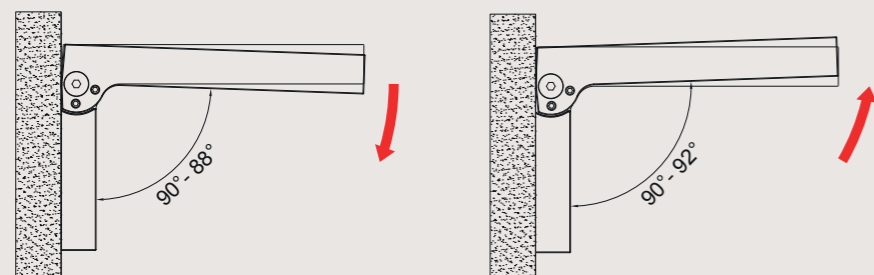

## B-428-SX

- Stabilizer angle bracket wall-glass, left version, adjustable for glass 8–10 mm
- Hoekstabilisatie wand-glas, uitvoering links, verstelbaar, voor glas 8–10 mm
- Èquerre da stabilisation, adjustable, gauche pour verre 8–10 mm

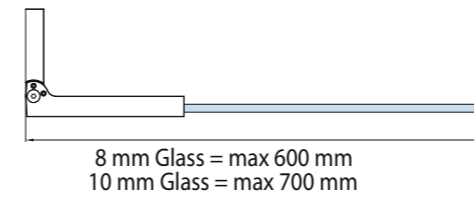

## B-428-DX

- Stabilizer angle bracket wall-glass, right version, adjustable for glass 8–10 mm
- Hoekstabilisatie wand-glas, uitvoering rechts, verstelbaar, voor glas 8–10 mm
- Èquerre da stabilisation, adjustable, droit pour verre 8–10 mm

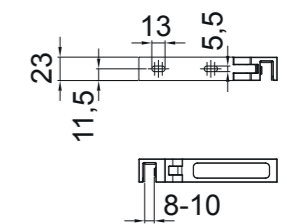
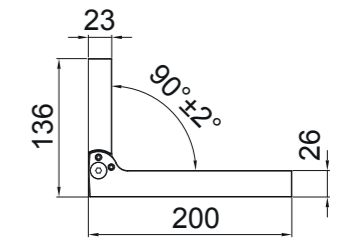
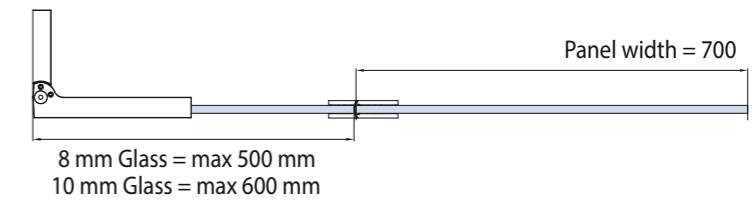

## B-429

- Stabilizer angle bracket glass-glass for glass 8–10 mm
- Hoekstabilisatie glas/glas, voor glas 8–10 mm
- Èquerre da stabilisation, verre-verre pour verre 8–10 mm

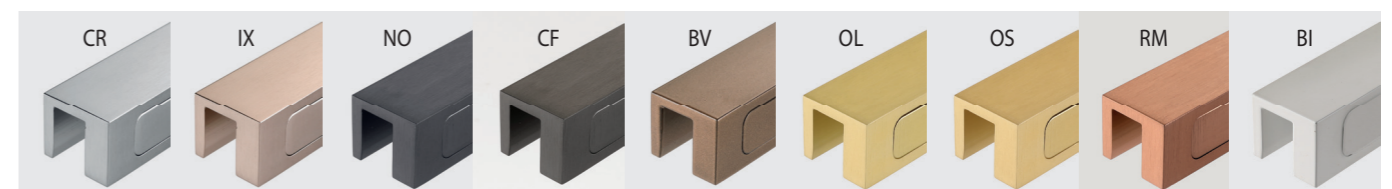
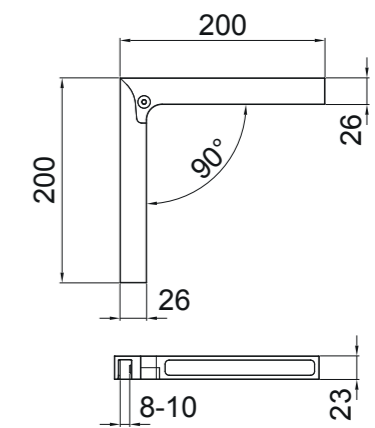
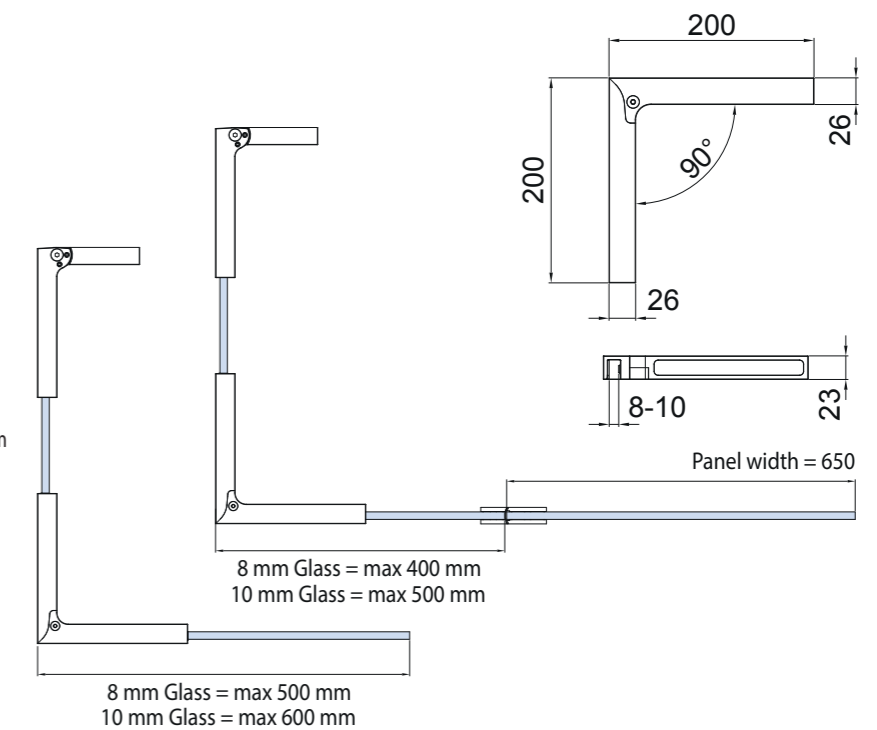

# BX-5000+COLORS

Product overview



P672



- Without glass preparation
- Zonder glasuitsparingen
- Sans usinage du verre

ATELIER *delle*  
FINITURE

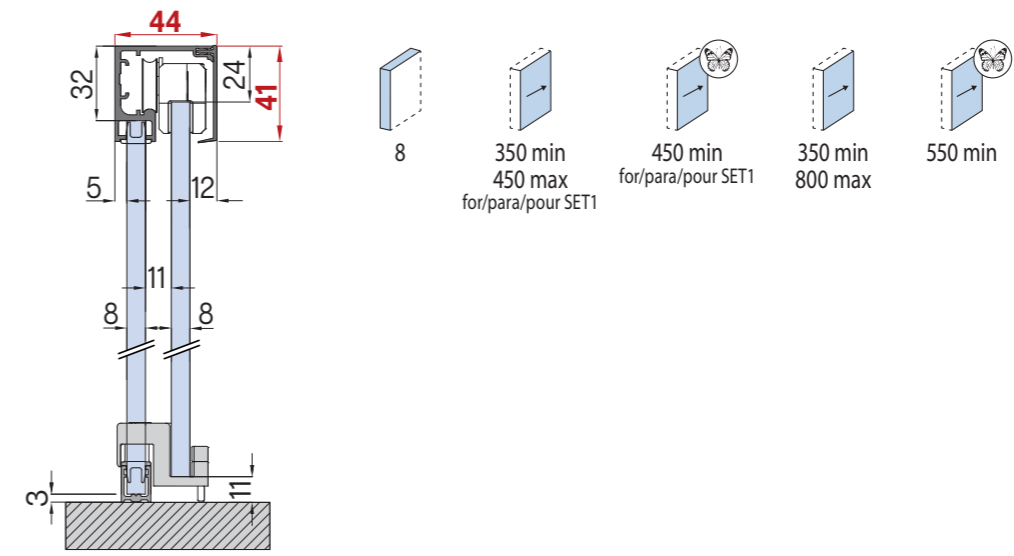

BX-5000-SET1

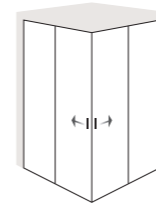

BX-5000-SET2

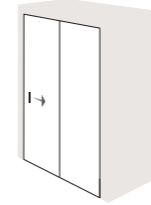

BX-5000-SET3

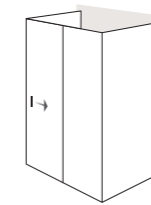

BX-5000-SET4

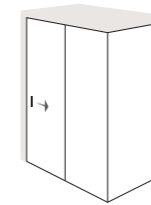

BX-5000-SET5

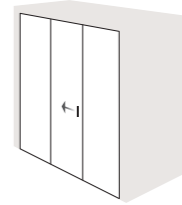

BX-5000-SET6

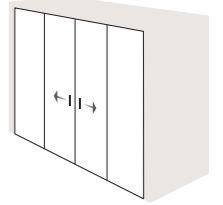

xme628

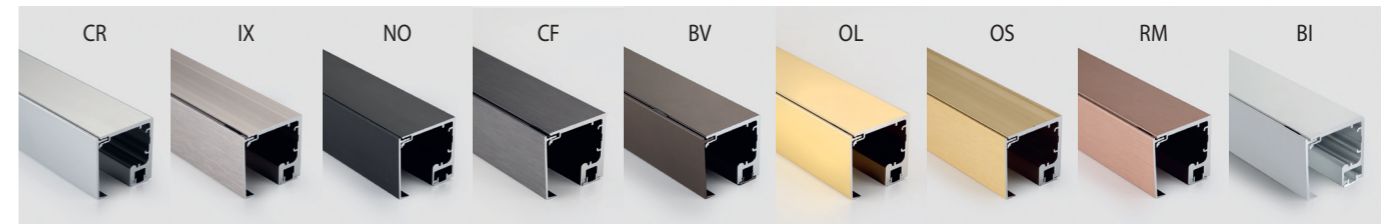

SHOWER BOXES

SHOWER BOXES



ATELIER *delle*  
FINITURE



SHOWER BOXES

SHOWER BOXES



**B-220**

- Square adjustable support bar wall-glass.
- Vierkante stabilisatieset wand/glas, verstelbaar
- Barre raidisseur carré mur-verre avec double articulation.

ART.	Length	Fin
B-220-500	1200 mm	CR, NS, NO
B-220-1500	1500 mm	CF, BV, OL, OS, RM, BI

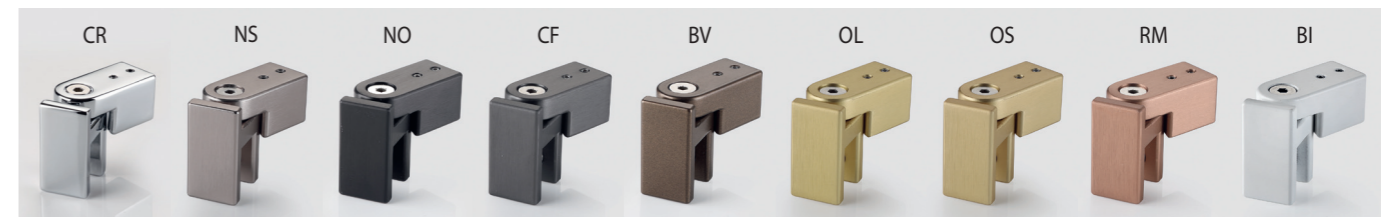
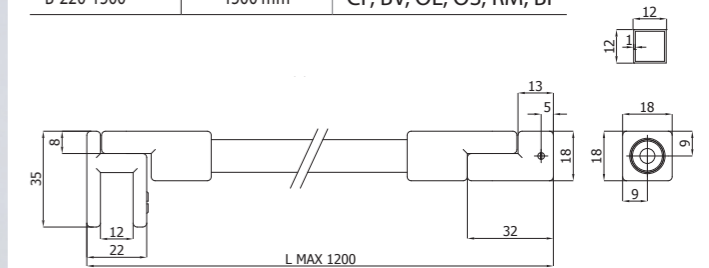

**B-223**

- Rectangular bar - cuttable to size.
- Stabilisatiebuis - inkortbaar.
- Barre rectangulaire recoupable.
- L = 1200 mm IL IX NO
- L = 1500 mm CF BV OL OS RM BI

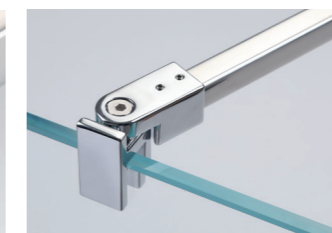
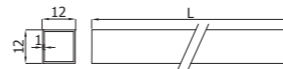

**B-225-R**

- Glass fitting with swivel clamp.
- Glasbevestiging met draaibare klem.
- Connecteur verre avec pince tournante.

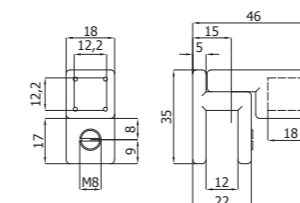

**B-224-R**

- Wall fitting with swivel clamp.
- Wandbevestiging met draaibare klem.
- Connecteur mural articulée.

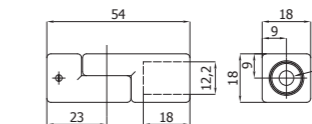

**B-222**

- Glass connector through with adjustable positioning on the bar.
- Glasdoorvoer met verstelbare positionering op de buis
- Connecteur verre passante avec positionnement réglable sur la barre.

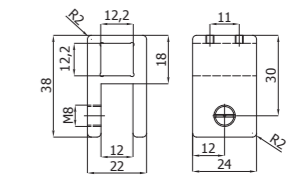

# ACCESSORIES

ACCESORIOS  
ACCESSOIRES

ATELIER *delle*  
FINITURE

Product overview



P191



## P-017

- Splash guard profile
- Dorpelprofiel
- Profil de protection au sol
- L = 2500 mm

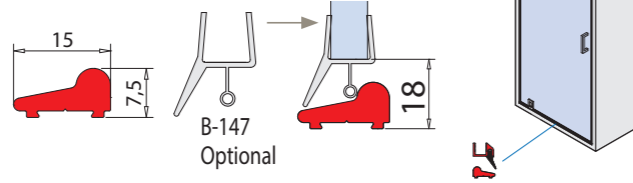

Product overview



P130

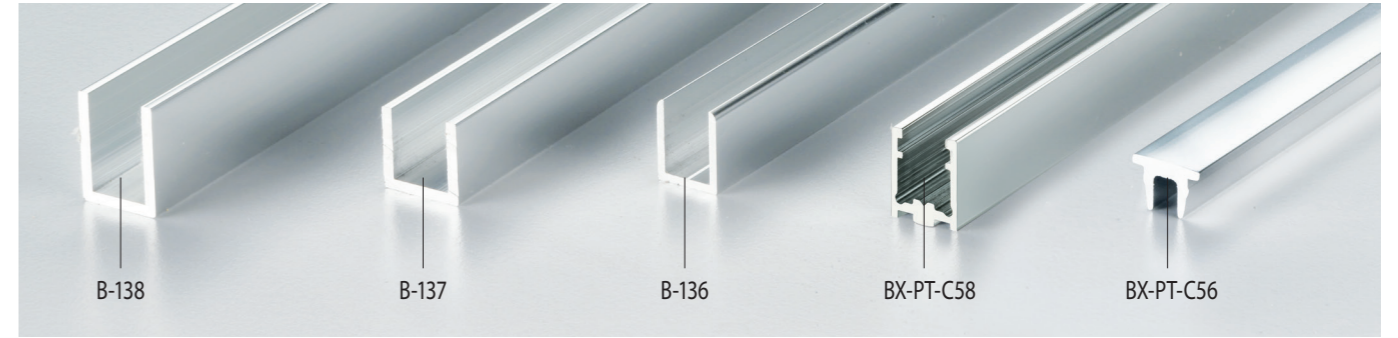

## B-138

- Aluminium "U" channel.
- Aluminium U-profiel.
- Profil en "U" aluminium.
- L = 3000 mm

## B-137

- Aluminium "U" channel.
- Aluminium U-profiel.
- Profil en "U" aluminium.
- L = 3000 mm

## B-136

- "U" channel.
- U-profiel.
- Profil en "U" aluminium.
- L = 3000 mm

## BX-PT-C58

- "U" channel.
- U-profiel.
- Profil en "U" aluminium.
- L = 1500 / 3000 mm

## BX-PT-C56

- Cover profile for floor profile BX-PT-C58, shower entry.
- Afdekprofiel voor vloerprofiel BX-PT-C58, douche-instap.
- Capot pour profil au sol BX-PT-C58, entrée de douche
- L = 1500 / 3000 mm

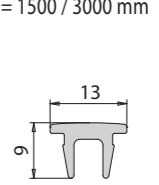
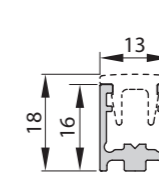
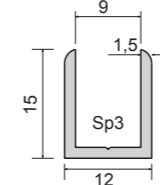
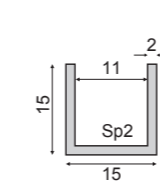
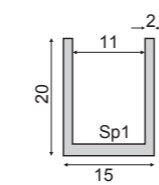

xla367c-2

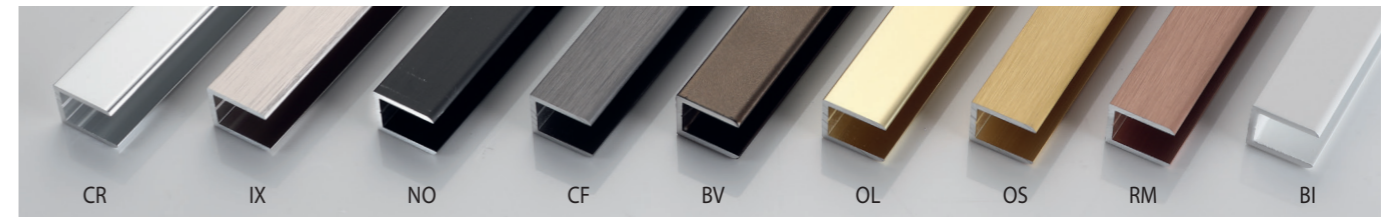

## BX-PT3-C57

- 90° joint for corner, for installation with profile P-017
- 90° hoekverbinding, voor montage met profiel P-017
- Raccord 90° pour profil P-017

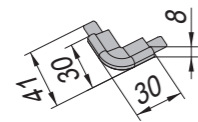

## BX-PT3-C60

- Pair endcaps for profile P-017, set 1 pc left + 1 pc right
- Paar eindkappen voor profiel P-017, set 1 links + 1 rechts
- Paires capuchons pour profil P-017, kit 1 U droite + 1 U gauche.

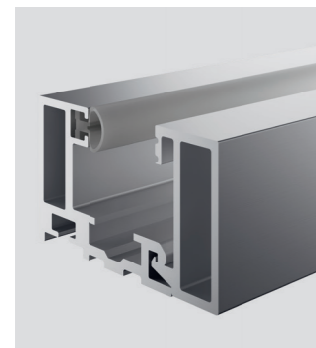
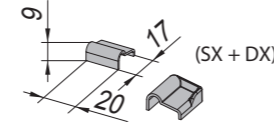

## DIV-050

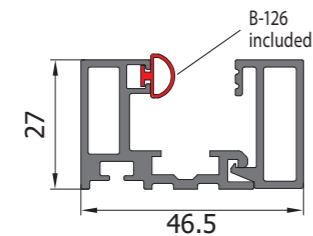

- Clip-on profiles for fixed panels
- Klikprofielen voor vaste panelen
- Profil de cloison de séparation à clipper

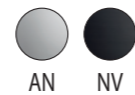

L = 3000 mm

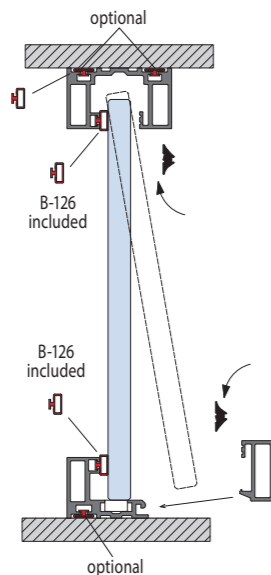

## VP-016

- For glass 8 mm
- Voor glas 8 mm
- Pour verre 8 mm

## VP-017

- For glass 10 and 13,5 mm
- For 13,5 mm remove B-126
- Voor glas 10 en 13,5 mm
- Voor 13,5 mm, B-126 verwijderen

## VP-018

- For glass 12 and 12,76 mm
- Voor glas 12 en 12,76 mm
- Pour verre de 12 et 12,76 mm

## POR-0400V

- Pc pullhandle with self-adhesive fixing
- Handgreep met zelfklevende bevestiging
- Poignée de tirage avec fixation adhésive,

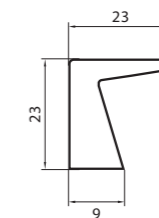

L = 240 mm



## MID-10-INC

- Pair handles with self-adhesive fixing
- Set handgrepen met zelfklevende bevestiging
- Paire poignées de tirage avec fixation adhésive

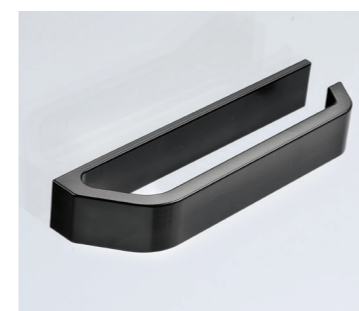
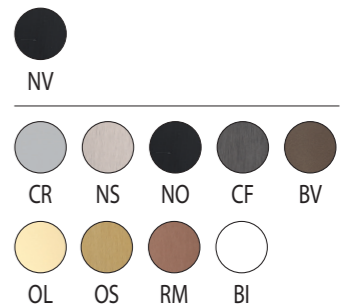
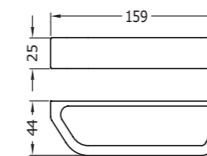

xme658

# ACCESSORIES

ACCESORIOS  
ACCESSOIRES



CR

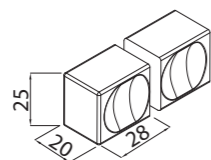

Product overview



P182

## B-196

- Pair of doorknobs 25 x 28 mm.
- Set deurknoppen 25 x 28 mm.
- Paire de boutons 25 x 28 mm.

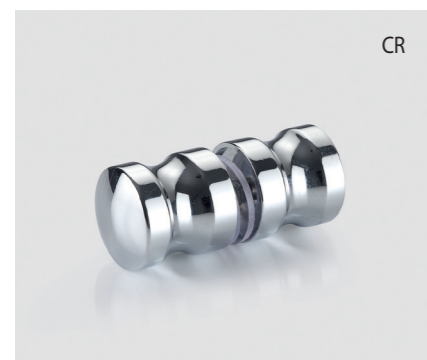
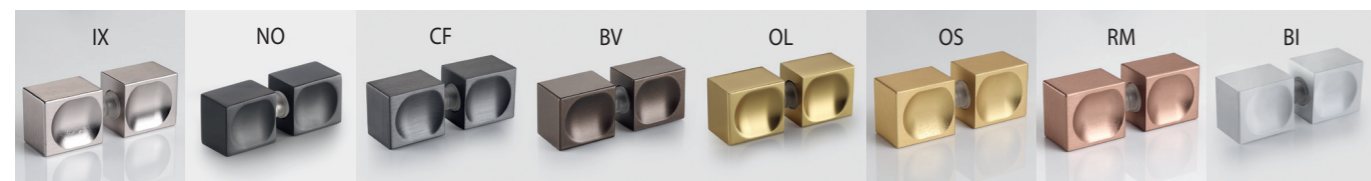

CR

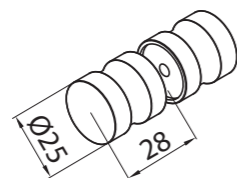

## V-024-25

- Pair of doorknobs Ø 25 mm.
- Set deurknoppen Ø 25 mm.
- Paire de boutons Ø 25 mm.

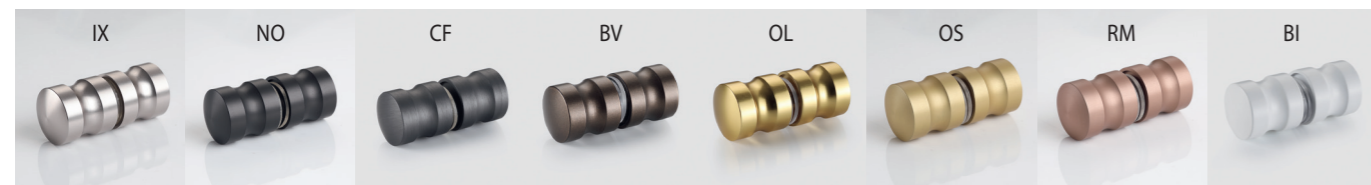

# ACCESSORIES

ACCESORIOS  
ACCESSOIRES



CR

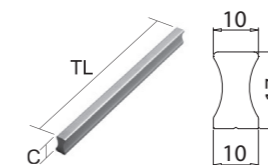

TL = 260 mm

Product overview



P640

## POR-0408V

- Pc pullhandle with self-adhesive fixing
- Handgreep met zelfklevende bevestiging
- Poignée de tirage avec fixation adhésive,

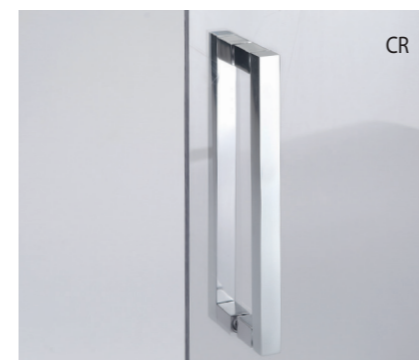
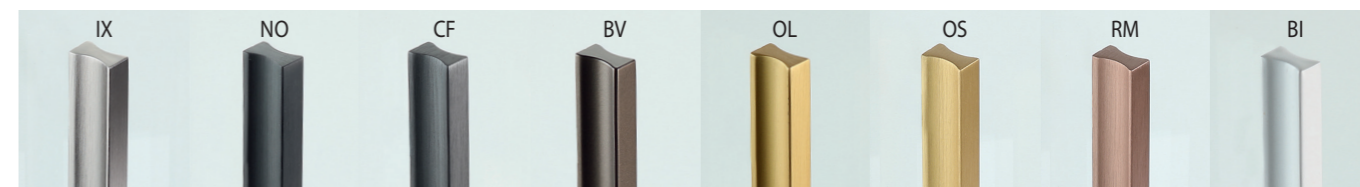

CR

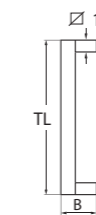

TL = 206 mm  
A = 192 mm

Product overview



P642

## SQUARE15

- Pair square pullhandles. Material: Aluminium
- Set vierkante handgrepen. Materiaal: aluminium
- Paire bâtons de maréchal section carrée. Matériau : Aluminium

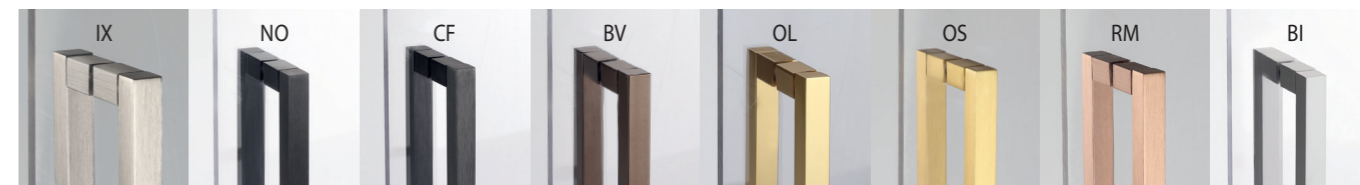

SHOWER BOXES

SHOWER BOXES



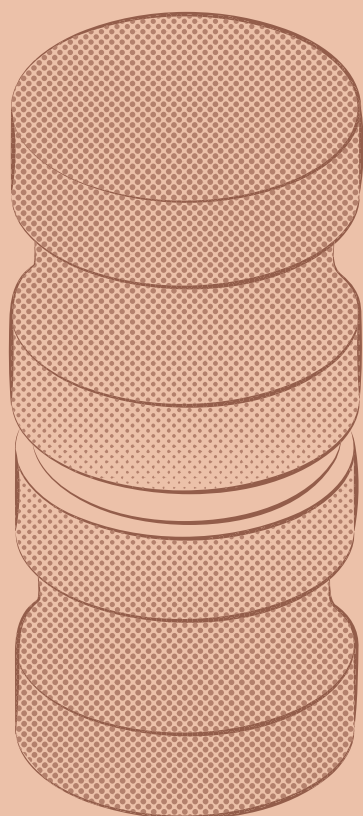
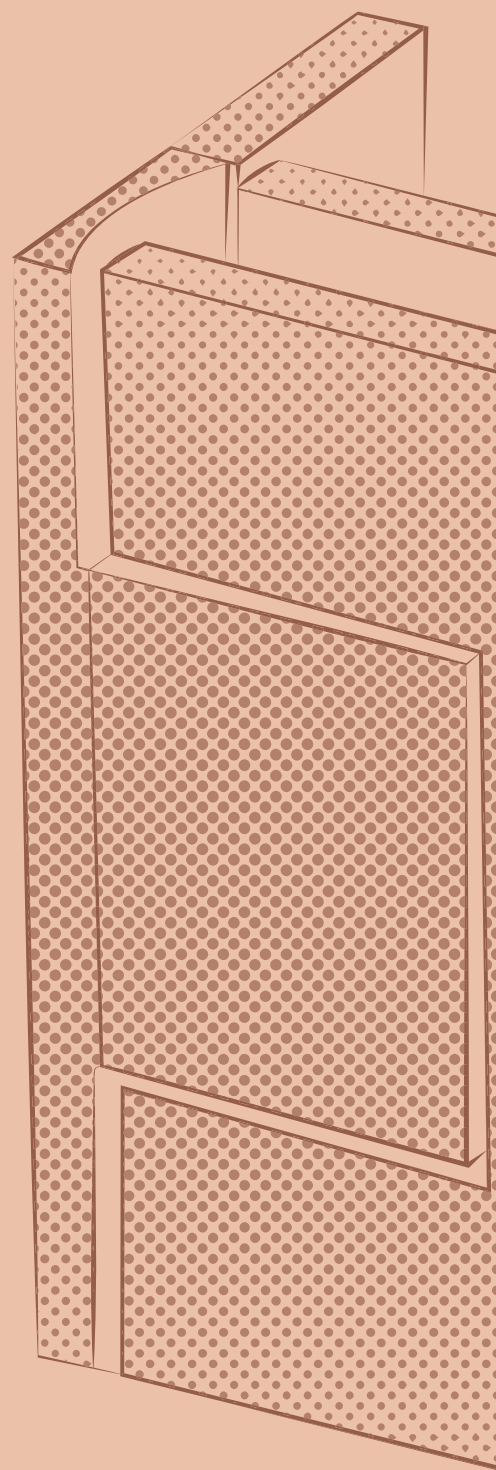
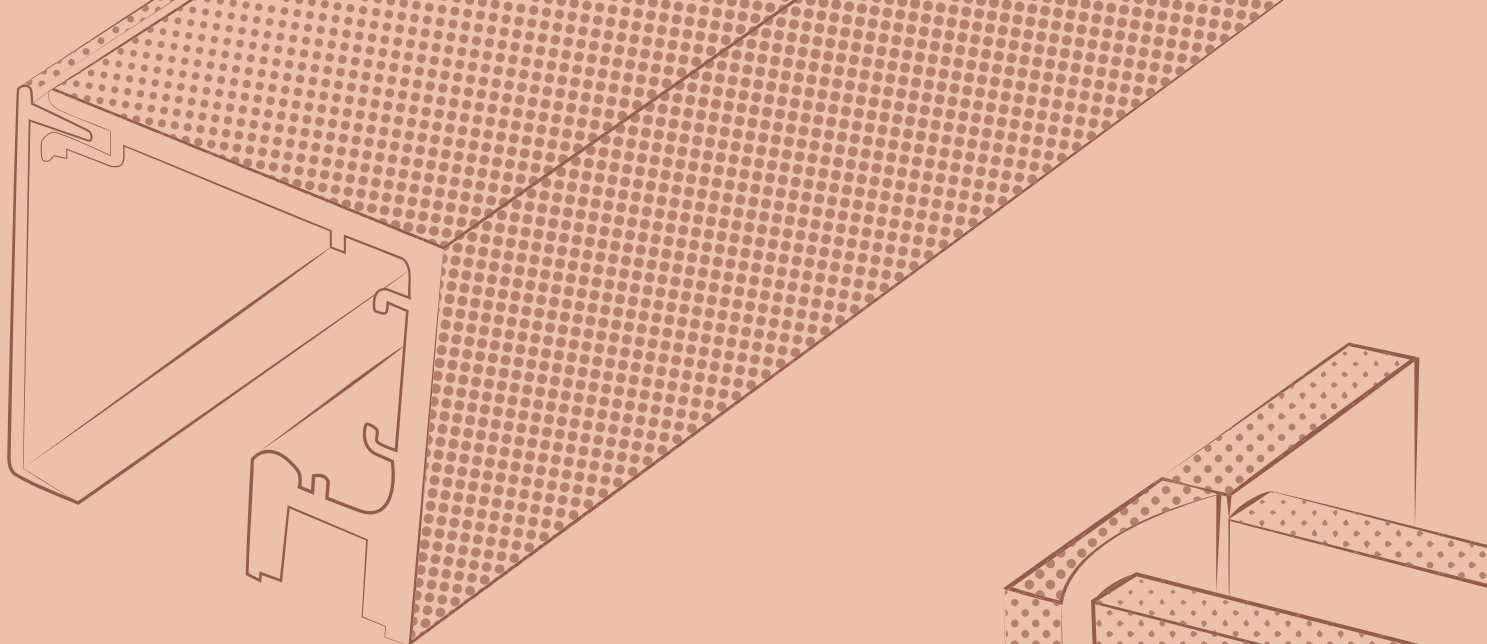

Minusco BENELUX



METALGLAS

B O N O M I

**Metalglas Bonomi s.r.l.**

Via Montini, 106/A

25065 Lumezzane S.A. (Brescia) Italy

Ph. +39 030 829910 - Fax +39 030 8920970

[www.metalglas.it](http://www.metalglas.it) - [info@metalglas.it](mailto:info@metalglas.it)