

# GLASS DOOR LOCK INSTALLATION INSTRUCTION

## FEATURES :

- Low noise latch design
- Clamp follower function
- Suitable for glass thickness 8~10mm
- 16/18mm handle holder for option
- Easy exchange DIN Left & Right side
- international Patented
- Adjustable spring force function

### DIN R Shown

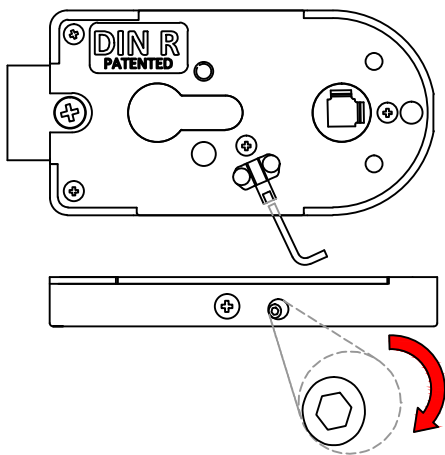

Turning Allen key clockwise to get stronger spring force

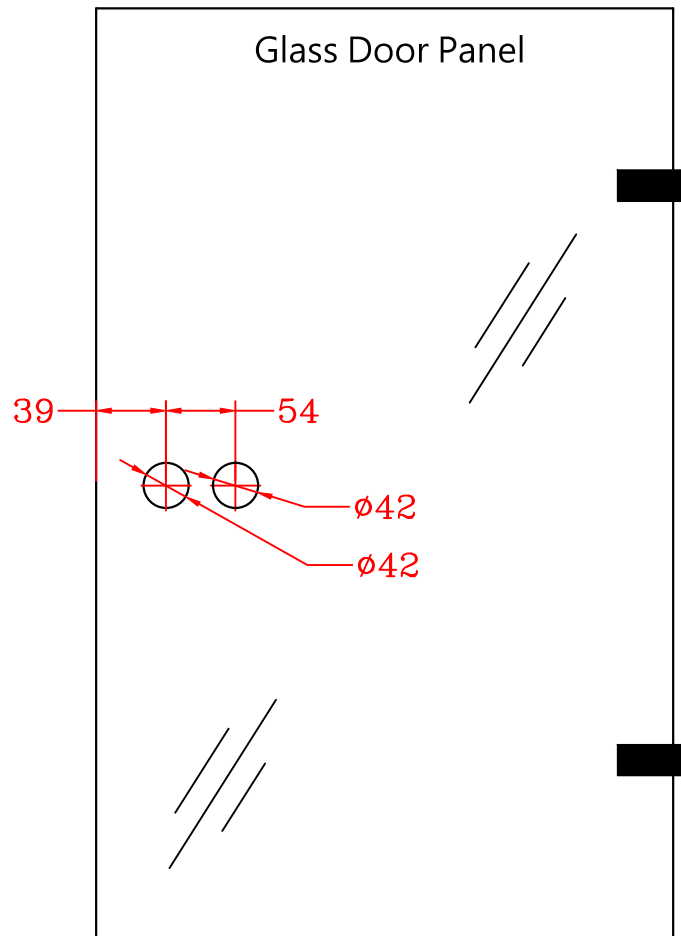

### DIN L Shown

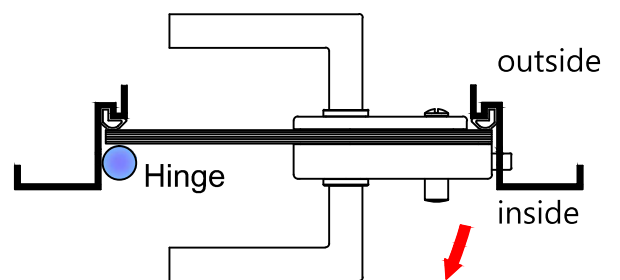
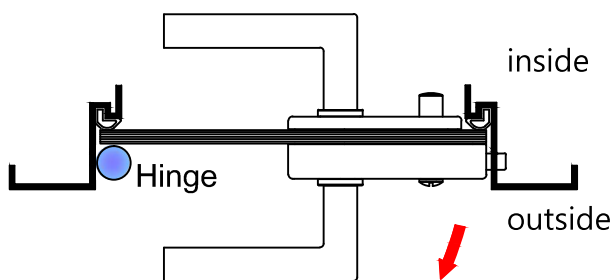

### DIN R Shown

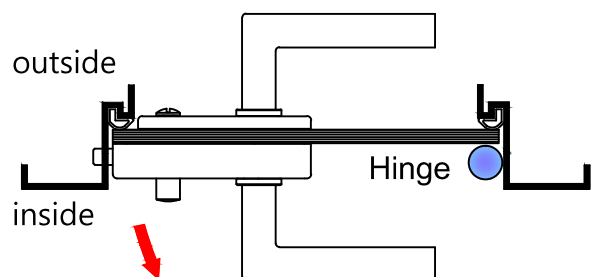
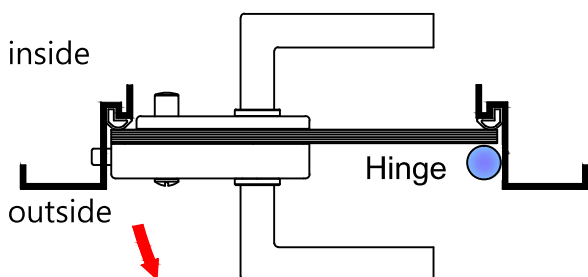

## Easy and fast exchanges turns

- A. Taking off 2pcs screw from the thick cover, then take off the lever holder cover & lever holder from the thick cover & thin cover
- B. Press the turn and sliding out the indicator link to release
- C. Interchanging position of lever thumb turn to release turn
- D. Press the turn and sliding in the indicator link to fix the position
- E. Fixing lever holder & lever holder cover on the thick cover & thin cover and fixing 2pcs screw in the thick cover,
- F. Check the indicator function to finish the installation

## DIN R Shown

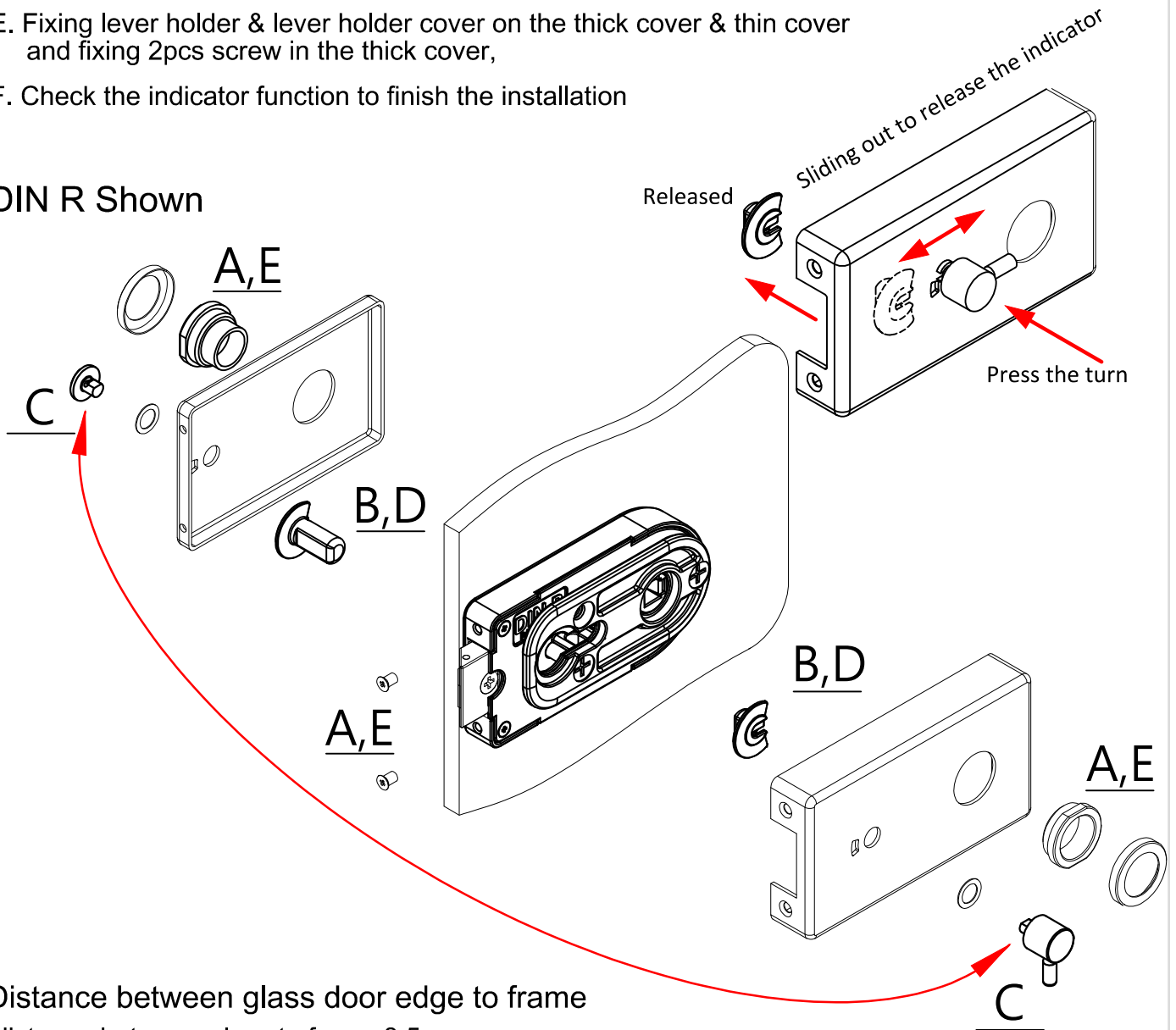

Distance between glass door edge to frame  
distance between glass to frame 3.5 mm

